



COOK

PLC

DATE: _____

PROJECT: _____

LOCATION: _____



Centrifugal Plenum Fan Arrangement 3

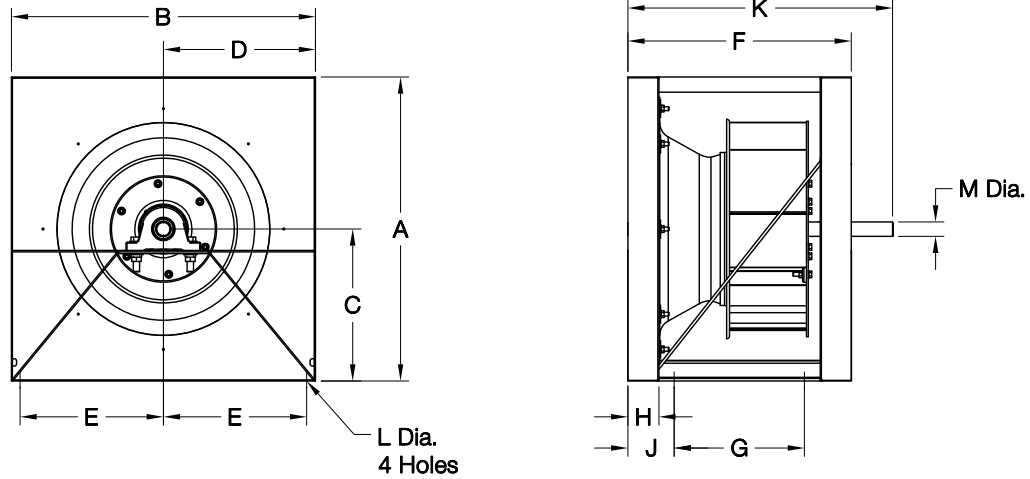

DIMENSION DATA

| Size | A | B | C | D | E | | | F | | | G | | | H | | |
|------|--------|--------|--------|--------|----------|----------|-----------|----------|----------|-----------|----------|----------|-----------|---------|----------|-----------|
| | | | | | Class I | Class II | Class III | Class I | Class II | Class III | Class I | Class II | Class III | Class I | Class II | Class III |
| 120 | 17-1/4 | 17-1/4 | 8-5/8 | 8-5/8 | 7-11/16 | 7-11/16 | - | 13-1/16 | 13-1/16 | - | 7-7/16 | 7-7/16 | - | 1-13/16 | 1-13/16 | - |
| 135 | 19-1/2 | 19-1/2 | 9-3/4 | 9-3/4 | 8-13/16 | 8-13/16 | - | 14-5/8 | 14-5/8 | - | 8-1/2 | 8-1/2 | - | 2-1/16 | 2-1/16 | - |
| 150 | 21-1/2 | 21-1/2 | 10-3/4 | 10-3/4 | 9-13/16 | 9-13/16 | - | 15-9/16 | 15-9/16 | - | 9-7/16 | 9-7/16 | - | 2-1/16 | 2-1/16 | - |
| 165 | 23-3/4 | 23-3/4 | 11-7/8 | 11-7/8 | 10-15/16 | 10-15/16 | - | 16-3/4 | 16-3/4 | - | 10-5/8 | 10-5/8 | - | 2-1/16 | 2-1/16 | - |
| 180 | 25-3/4 | 25-3/4 | 12-7/8 | 12-7/8 | 12 | 12 | 11-9/16 | 19-7/8 | 19-7/8 | 20-15/16 | 11-3/4 | 11-3/4 | 10-3/4 | 3-1/16 | 3-1/16 | 3-1/16 |
| 195 | 28 | 28 | 14 | 14 | 13-1/8 | 13-1/8 | 12-11/16 | 21 | 21 | 22-1/16 | 12-7/8 | 12-7/8 | 11-7/8 | 3-1/16 | 3-1/16 | 3-1/16 |
| 210 | 30 | 30 | 15 | 15 | 14-1/8 | 14-1/8 | 13-11/16 | 22-1/16 | 22-1/16 | 23-1/8 | 13-15/16 | 13-15/16 | 12-15/16 | 3-1/16 | 3-1/16 | 3-1/16 |
| 225 | 32-1/4 | 32-1/4 | 16-1/8 | 16-1/8 | 15-1/4 | 15-5/16 | 14-13/16 | 23-1/16 | 23-1/16 | 24-1/8 | 14-15/16 | 14-15/16 | 13-15/16 | 3-1/16 | 3-1/16 | 3-1/16 |
| 245 | 35 | 35 | 17-1/2 | 17-1/2 | 16-3/8 | 16-7/16 | 16-3/16 | 24-1/2 | 24-1/2 | 25-9/16 | 15-7/8 | 15-7/8 | 15-3/8 | 3-1/16 | 3-1/16 | 3-1/16 |
| 270 | 38-3/4 | 38-3/4 | 19-3/8 | 19-3/8 | 18-1/4 | 18-5/16 | 18-1/16 | 27-7/16 | 27-7/16 | 29 | 17-13/16 | 17-13/16 | 17-5/16 | 3-9/16 | 3-9/16 | 3-9/16 |
| 300 | 43 | 43 | 21-1/2 | 21-1/2 | 20-3/16 | 20-3/16 | 20-3/16 | 29-1/2 | 29-1/2 | 31-1/16 | 19-3/8 | 19-3/8 | 19-3/8 | 3-9/16 | 3-9/16 | 3-9/16 |
| 330 | 49-1/2 | 46 | 23-5/8 | 23 | 22-5/16 | 22-1/4 | 22-1/4 | 32-3/16 | 34-3/16 | 34-3/16 | 26-3/8 | 27-3/8 | 27-3/8 | 3-9/16 | 4-9/16 | 4-9/16 |
| 365 | 53-1/2 | 49 | 26-1/8 | 24-1/2 | 23-13/16 | 23-3/4 | 23-3/4 | 34-9/16 | 36-5/8 | 36-5/8 | 28-3/4 | 29-13/16 | 29-13/16 | 3-9/16 | 4-9/16 | 4-9/16 |
| 402 | 60 | 54 | 28-3/4 | 27 | 26-1/4 | 26-1/4 | 26-1/8 | 39-7/16 | 40-15/16 | 41 | 32-5/8 | 33-5/8 | 33-5/8 | 4-9/16 | 5-1/16 | 5-1/8 |
| 445 | 64 | 58-1/2 | 31-7/8 | 29-1/4 | 28-1/2 | 28-3/8 | 28-3/8 | 43 | 45 | 45 | 35-5/8 | 36-5/8 | 36-5/8 | 5-1/8 | 6-1/8 | 6-1/8 |
| 490 | 70 | 63 | 35 | 31-1/2 | 30-5/8 | 30-1/2 | 30-1/2 | 47-1/4 | 50-11/16 | 50-11/16 | 39-7/8 | 41-7/8 | 41-7/8 | 5-1/8 | 6-9/16 | 6-9/16 |
| 540 | 75 | 69 | 38-5/8 | 34-1/2 | 33-5/8 | 33-1/2 | 33-1/2 | 50-7/8 | 54-3/8 | 54-3/8 | 43-1/2 | 45-1/2 | 45-1/2 | 5-1/8 | 6-5/8 | 6-5/8 |
| 600 | 82 | 75 | 42-7/8 | 37-1/2 | 36-5/8 | 36-1/2 | 36-1/2 | 56-1/4 | 59-1/4 | 59-1/4 | 47-7/8 | 49-7/8 | 49-7/8 | 6-1/8 | 7-1/8 | 7-1/8 |
| 660 | 90 | 82 | 47-1/4 | 41 | 40 | 39-11/16 | 39-11/16 | 63-11/16 | 64-11/16 | 64-11/16 | 54-5/16 | 54-5/16 | 54-5/16 | 7-1/8 | 8-1/8 | 8-1/8 |
| 730 | 92 | 92 | 52-1/4 | 46 | 45 | 44-11/16 | 44-11/16 | 69-11/16 | 69-3/4 | 69-3/4 | 59-5/16 | 59-3/8 | 59-3/8 | 8-1/8 | 8-1/8 | 8-1/8 |

| Size | J | | | K | | | L | | | M | | | Shipping Weights | | |
|------|---------|----------|-----------|----------|----------|-----------|---------|----------|-----------|---------|----------|-----------|------------------|----------|-----------|
| | Class I | Class II | Class III | Class I | Class II | Class III | Class I | Class II | Class III | Class I | Class II | Class III | Class I | Class II | Class III |
| 120 | 2-13/16 | 2-13/16 | - | 16-15/16 | 17-5/16 | - | 5/8 | 5/8 | - | 1-3/16 | 1-7/16 | - | 112 | 117 | - |
| 135 | 3-1/16 | 3-1/16 | - | 18-1/2 | 18-7/8 | - | 5/8 | 5/8 | - | 1-3/16 | 1-7/16 | - | 127 | 132 | - |
| 150 | 3-1/16 | 3-1/16 | - | 19-1/2 | 19-7/8 | - | 5/8 | 5/8 | - | 1-3/16 | 1-7/16 | - | 139 | 147 | - |
| 165 | 3-1/16 | 3-1/16 | - | 20-11/16 | 21-1/16 | - | 5/8 | 5/8 | - | 1-3/16 | 1-7/16 | - | 159 | 165 | - |
| 180 | 4-1/16 | 4-1/16 | 4-9/16 | 24-1/16 | 24-3/16 | 25-11/16 | 5/8 | 5/8 | 5/8 | 1-7/16 | 1-7/16 | 1-15/16 | 212 | 212 | 247 |
| 195 | 4-1/16 | 4-1/16 | 4-9/16 | 25-1/8 | 25-1/4 | 26-15/16 | 5/8 | 5/8 | 5/8 | 1-7/16 | 1-7/16 | 1-15/16 | 228 | 233 | 280 |
| 210 | 4-1/16 | 4-1/16 | 4-9/16 | 26-3/16 | 26-7/16 | 28 | 5/8 | 5/8 | 5/8 | 1-7/16 | 1-7/16 | 1-15/16 | 245 | 252 | 301 |
| 225 | 4-1/16 | 4-1/16 | 4-9/16 | 27-3/16 | 27-7/16 | 29-1/8 | 5/8 | 5/8 | 5/8 | 1-7/16 | 1-11/16 | 1-15/16 | 273 | 292 | 334 |
| 245 | 4-5/16 | 4-5/16 | 4-9/16 | 28-13/16 | 29-1/16 | 30-9/16 | 5/8 | 5/8 | 5/8 | 1-7/16 | 1-15/16 | 2-3/16 | 328 | 366 | 366 |
| 270 | 4-13/16 | 4-13/16 | 5-1/16 | 31-11/16 | 32-1/16 | 34-1/4 | 5/8 | 5/8 | 5/8 | 1-7/16 | 1-15/16 | 2-7/16 | 407 | 441 | 449 |
| 300 | 5-1/16 | 5-1/16 | 5-1/16 | 33-15/16 | 34-5/16 | 36-9/16 | 5/8 | 5/8 | 5/8 | 1-11/16 | 2-3/16 | 2-7/16 | 513 | 553 | 571 |
| 330 | 4-11/16 | 5-11/16 | 5-11/16 | 36-13/16 | 39-1/16 | 39-13/16 | 15/16 | 15/16 | 15/16 | 1-15/16 | 2-3/16 | 2-7/16 | 599 | 633 | 684 |
| 365 | 4-11/16 | 5-11/16 | 5-11/16 | 39-3/8 | 41-5/8 | 42-1/2 | 15/16 | 15/16 | 15/16 | 1-15/16 | 2-3/16 | 2-11/16 | 650 | 713 | 840 |
| 402 | 5-11/16 | 6-3/16 | 6-1/4 | 44-7/16 | 46-1/4 | 47-3/8 | 15/16 | 15/16 | 15/16 | 2-7/16 | 2-3/16 | 2-15/16 | 946 | 950 | 1118 |
| 445 | 6-1/4 | 7-1/4 | 7-1/4 | 48-1/8 | 50-3/4 | 51-7/8 | 15/16 | 15/16 | 15/16 | 2-7/16 | 2-7/16 | 3-7/16 | 1220 | 1258 | 1469 |
| 490 | 6-1/4 | 7-11/16 | 7-11/16 | 52-5/8 | 56-13/16 | 58-1/16 | 15/16 | 1-1/16 | 1-1/16 | 2-7/16 | 2-11/16 | 3-7/16 | 1489 | 1597 | 1754 |
| 540 | 6-1/4 | 7-3/4 | 7-3/4 | 56-1/2 | 61 | 62-3/8 | 1-1/16 | 1-1/16 | 1-1/16 | 2-7/16 | 2-15/16 | 3-7/16 | 1584 | 1776 | 1947 |
| 600 | 7-1/4 | 8-1/4 | 8-1/4 | 62-1/4 | 66-5/8 | 68-1/8 | 1-1/16 | 1-1/16 | 1-1/16 | 2-11/16 | 3-7/16 | 3-15/16 | 1982 | 2216 | 2452 |
| 660 | 8-1/4 | 9-1/4 | 9-1/4 | 70-5/16 | 72-13/16 | 74-7/16 | 1-1/16 | 1-1/16 | 1-1/16 | 2-15/16 | 3-7/16 | 3-15/16 | 2547 | 2824 | 3234 |
| 730 | 9-1/4 | 9-1/4 | 9-1/4 | 76-15/16 | 78-7/8 | 80-5/8 | 1-1/16 | 1-1/16 | 1-1/16 | 3-7/16 | 3-7/16 | 4-7/16 | 3094 | 3265 | 3886 |

ALL DIMENSIONS IN INCHES. WEIGHTS IN LBS., LESS MOTOR.

PL001R02