

MARK: \_\_\_\_\_

PROJECT: \_\_\_\_\_

DATE: \_\_\_\_\_



## Centri-Vane All Aluminum Inline Centrifugal Blower Direct Drive

### DIMENSION DATA

| Size | A  | B       | C       | D        | E      | F       | G      | Wheel Dia. | Ga. of Alum. | Ship Wt. less Mtr. |
|------|----|---------|---------|----------|--------|---------|--------|------------|--------------|--------------------|
| 8    | 8  | 13-1/4  | 13-7/16 | 7        | 1-5/16 | 11-1/4  | 10-1/4 | 10-1/4     | .080         | 35                 |
| 10   | 10 | 15      | 16-3/16 | 8-11/16  | 1-5/16 | 13      | 12-1/4 | 12-15/16   | .080         | 65                 |
| 12   | 12 | 17-1/8  | 19-1/4  | 9-15/16  | 1-5/16 | 15-1/8  | 14-1/8 | 15-9/16    | .080         | 82                 |
| 14   | 14 | 19-1/8  | 22      | 11-7/16  | 1-5/16 | 17-1/8  | 16-1/4 | 18-1/4     | .080         | 93                 |
| 16   | 16 | 21-9/16 | 24-7/8  | 12-11/16 | 1-5/16 | 19-9/16 | 18-1/4 | 20-15/16   | .100         | 120                |
| 18   | 18 | 24-1/2  | 27-3/4  | 14       | 1-5/16 | 22-1/2  | 20-3/8 | 23-9/16    | .100         | 166                |
| 20   | 20 | 26-3/8  | 30-1/2  | 15-3/4   | 1-5/16 | 24-3/8  | 22-1/2 | 26-1/4     | .100         | 206                |

ALL DIMENSIONS IN INCHES. WEIGHTS IN LBS.

### STANDARD CONSTRUCTION FEATURES:

All aluminum construction - All angle operation - Straightening vanes -  
Prewired twist lock disconnect - Aluminum support bracket with extruded  
rubber isolator - Five year warranty.

### ACCESSORIES

1. INLET SCREEN OUTLET
2. SCREEN VIBRATION PADS
3. VOLUME CONTROL DAMPER
4. INLET VANE DAMPER
5. FLEXIBLE DUCT CONNECTOR
6. COMPANION FLANGE
7. EISEN-HEISS COATING
8. EPOXY COATING

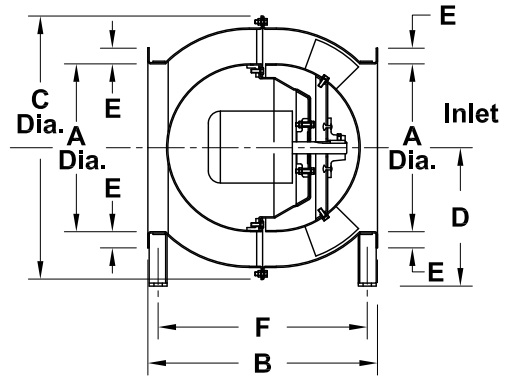
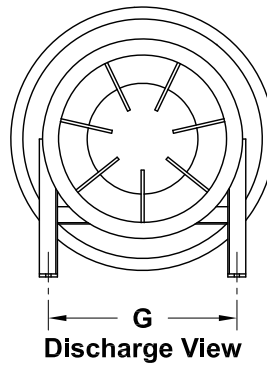

| QTY | MARK | CATALOG NUMBER | FAN INFORMATION |    |     | MOTOR INFORMATION |       |    |    |      | ACCESSORIES |  |  |  |  |  |  |  |
|-----|------|----------------|-----------------|----|-----|-------------------|-------|----|----|------|-------------|--|--|--|--|--|--|--|
|     |      |                | CFM             | SP | RPM | HP                | VOLTS | HZ | PH | TYPE |             |  |  |  |  |  |  |  |
|     |      |                |                 |    |     |                   |       |    |    |      |             |  |  |  |  |  |  |  |