



# COOK VCRD/VCRD-HP/VCRD-XP

DATE: \_\_\_\_\_  
 PROJECT: \_\_\_\_\_  
 LOCATION: \_\_\_\_\_



**Upblast Centrifugal  
 Exhaust Ventilator  
 Hurricane / Missile Impact Resistant  
 Roof Mounted/Direct Drive**

## DIMENSION DATA

| Size | A        | B        | C        |         |          | D       | G | T Sq. | Ship Wt. | Roof Opening Sq. |
|------|----------|----------|----------|---------|----------|---------|---|-------|----------|------------------|
|      |          |          | VCRD     | VCRD-HP | VCRD-XP  |         |   |       |          |                  |
| 100  | 12-1/2   | 25-1/4   | 21-15/16 | -       | -        | 16-1/2  | 2 | 18    | 30       | 13-1/2           |
| 120  | 19-1/16  | 30-3/16  | 28-1/4   | -       | -        | 20-1/8  | 2 | 20    | 61       | 15-1/2           |
| 135  | 19-1/16  | 30-3/16  | 28-5/8   | -       | -        | 20-1/8  | 2 | 20    | 66       | 15-1/2           |
| 150  | 20-15/16 | 34-11/16 | 30-1/4   | 27-1/2  | -        | 23-9/16 | 2 | 24    | 77       | 19-1/2           |
| 165  | 20-15/16 | 34-11/16 | 30-3/4   | 27-3/4  | 26-11/16 | 23-9/16 | 2 | 24    | 83       | 19-1/2           |
| 180  | 24-13/16 | 39-7/16  | 35-7/8   | 33-3/8  | 31-9/16  | 25-7/8  | 3 | 30    | 100      | 25-1/2           |
| 195  | 24-13/16 | 39-7/16  | -        | 33-1/2  | 32-1/8   | 25-7/8  | 3 | 30    | 110      | 25-1/2           |

ALL DIMENSIONS IN INCHES. WEIGHTS IN LBS.  
 \* ROOF OPENING SIZE FOR CURBS SUPPLIED BY COOK ONLY.

LISTED POWER VENTILATOR FOR RESTAURANT  
 EXHAUST APPLICATIONS - 327Y.

MAXIMUM OPERATING TEMPERATURE  
 300°F (UL 762)

**MIAMI-DADE COUNTY, FLORIDA**  
**Notice of Acceptance (NOA) Number 17-0925.02/11-13-2023**  
 -TAS-201: Large Missile Impact Test  
 -TAS-202: Uniform Static Air Pressure Test  
 -TAS-203: Cyclic Wind Pressure Test

**STANDARD CONSTRUCTION FEATURES:**  
 All aluminum housing - Backward inclined all aluminum wheel -  
 Removable top cap - One piece bottom spinning - Welded curb cap corners -  
 Permanently lubricated ball bearing motors - Corrosion resistant fasteners  
 - Transit tested packaging

### ACCESSORIES

1. DISCONNECT SWITCH
2. RCG GALVANIZED CURB
3. VE VENTED EXTENSION
4. HINGED BASE
5. GREASE TERMINATOR
6. GREASE TROUGH

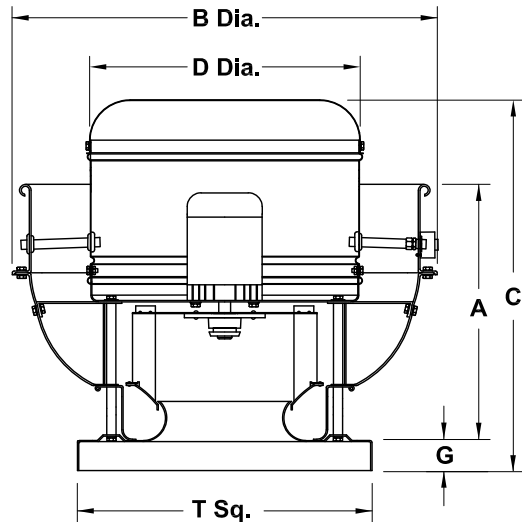

| QTY | MARK | CATALOG NUMBER | FAN INFORMATION |    |     | MOTOR INFORMATION |       |    |    |      | ACCESSORIES |  |  |
|-----|------|----------------|-----------------|----|-----|-------------------|-------|----|----|------|-------------|--|--|
|     |      |                | CFM             | SP | RPM | HP                | VOLTS | HZ | PH | TYPE |             |  |  |
|     |      |                |                 |    |     |                   |       |    |    |      |             |  |  |

**MOTOR TYPE: ODP (OPEN DRIP-PROOF); 2 SP (2 SPEED); X-PRF (EXPLOSION PROOF); TEFC (TOTALLY ENCLOSED FAN COOLED).**

RE004R02