



# COOK

# Inspection Section

DATE: \_\_\_\_\_

Accessory Data Sheet

PROJECT: \_\_\_\_\_

AI

LOCATION: \_\_\_\_\_

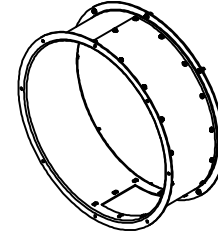

INSPECTION SECTION DOOR

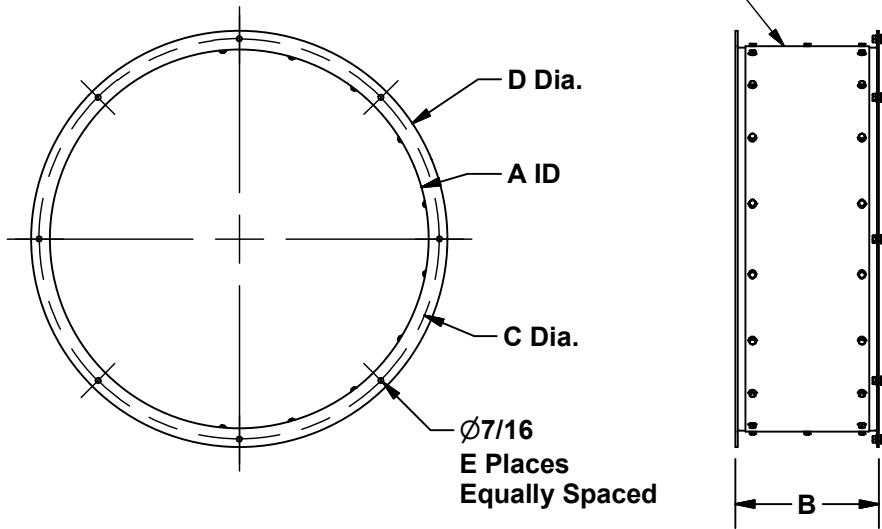

### STANDARD CONSTRUCTION FEATURES:

Steel construction - Bolted Access Door - Lorenized finish

### DIMENSION DATA

Size	A	B	C	D	E.	Accessory Weight
31	12 1/2	11	14 1/8	15 1/4	8	19
36	14 1/2	11	16 1/8	17 1/4	8	22
41	16 1/2	11 3/16	18 1/8	19 1/4	8	25
47	18 5/8	11 3/16	20 1/4	21 3/4	8	29
54	21 5/8	11 5/16	23 5/16	24 3/4	8	40
63	24 5/8	11 5/16	26 5/16	27 7/8	8	45
72	28 7/8	12 5/16	30 9/16	32 1/8	8	56
80	32 7/8	12 7/16	34 3/4	36 1/8	8	78
90	37	15 3/4	39 1/4	41 1/4	8	141
103	41 1/8	15 3/4	43 3/8	45 3/8	8	156
113	45 1/4	16 3/4	47 1/2	49 1/2	8	179
123	49 3/8	16 3/4	51 5/8	53 3/4	16	197
140	56	16 3/4	58 1/4	60 3/8	16	222
160	64 1/8	16 3/4	66 3/8	68 1/2	16	254

ALL DIMENSIONS IN INCHES. WEIGHTS IN LBS.

X0585R00