

DATE: \_\_\_\_\_

PROJECT: \_\_\_\_\_

LOCATION: \_\_\_\_\_

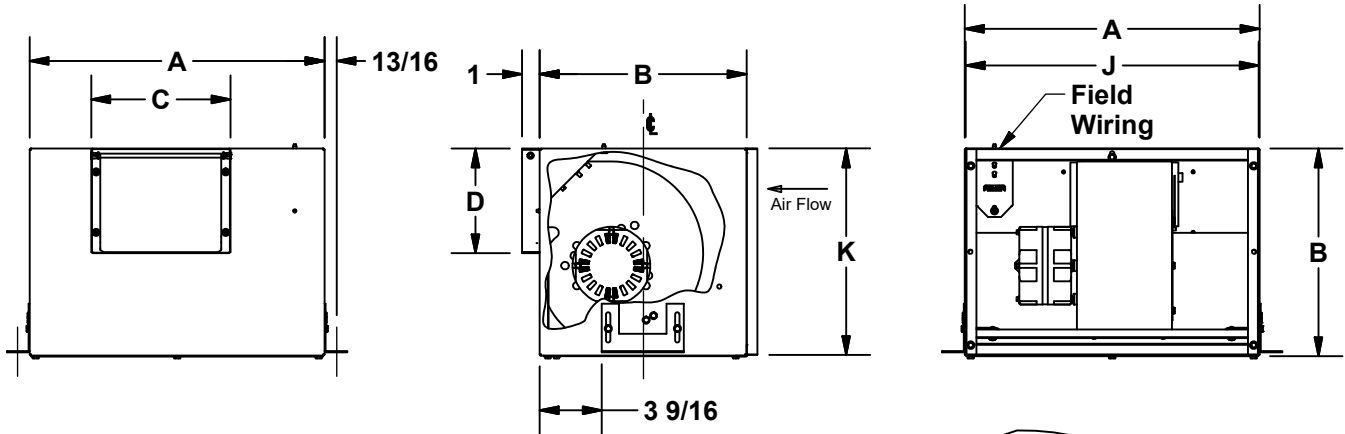

**Inline Blowers**  
**200 thru 700 Series**

**STANDARD CONSTRUCTION FEATURES:**

Forward curved galvanized steel fan wheels - Corrosion resistant galvanized steel fan housing - Acoustically insulated housing - Aluminum backdraft damper with solid aluminum hinge rod mounted in nylon bushings - Permanently lubricated motor with built-in thermal overload protection and disconnect plug - Interchangeable panels with removable fasteners allows the intake to be easily changed - Internal wiring box with disconnect receptacle

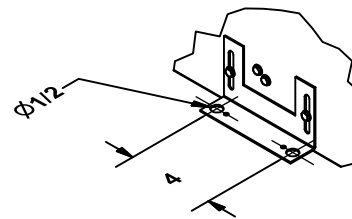

**MOUNTING BRACKET  
DETAIL**

**DIMENSION DATA**

Fan Size GN-	DIM A	DIM B	DIM C	DIM D	Inlet Dim J	Inlet Dim K	Ship Wt.
222, 242	12 3/8	9 3/4	6	4 1/2	12 5/16	9 11/16	22
322, 342	12 3/8	10 7/8	8	6	12 5/16	10 11/16	25
422	17	12	8	6	16 15/16	11 15/16	30
522, 542	17	12	8	6	16 15/16	11 15/16	32
622, 642	17	12	10 1/2	4 3/4	16 15/16	11 15/16	35
720, 740	17	12	10 1/2	4 3/4	16 15/16	11 15/16	36

ALL DIMENSIONS IN INCHES. WEIGHTS IN LBS.

**ACCESSORIES**

1. FAN SPEED CONTROL (FSC)
2. ROOF JACK
3. ROOF CAP
4. WALL CAP
5. EAVE ELBOW (322-740)
6. FILTER
7. BRICK VENT
8. CEILING RADIATION DAMPER
9. HANGING VIBRATION ISOLATOR
10. TIME DELAY SWITCH
11. 277 VOLT TRANSFORMER
12. 8" ROUND WALL CAP WITH DAMPER (222-522)
13. 6" & 8" ROUND DUCT DAMPER (222-522)
14. ROOF CURB

QTY	MARK	CATALOG NUMBER (see above)	FAN INFORMATION			MOTOR INFORMATION				ACCESSORIES			
			CFM	SP	RPM	HP	VOLTS	HZ	PH		TYPE		

**MOTOR TYPE: PSC** (Permanent Split Capacitor)