

DATE: _____

PROJECT: _____

LOCATION: _____



Vari-Plume®
Laboratory Exhaust
Mixed-Flow Inline
Belt Drive
With Mixing Box

DIMENSION DATA

Size	A	B	C	D	E	F	G	H	J	Approx. Ship Wt.
90	92	28	27 3/16	23	38	34	10 9/16	8	19 3/4	780
120	100	28	27 3/16	28	40 7/16	35	12 13/16	8	19 3/4	1050
135	108	28	27 1/8	28	41 5/8	36	14 13/16	8	18 9/16	1250
150	120	30	29 1/8	36	44 1/8	38	16 9/16	8	20 9/16	1380
165	125	32	31 1/8	36	45 1/2	41	18 5/16	8	22 9/16	1580
180	133	34	33 1/8	43	48	44	19 1/16	8	24 9/16	1830
202	143	38	36 15/16	50	51 7/8	49	22 9/16	8	28 9/16	1900
225	154	42	40 15/16	50	58	54	22 9/16	9	30 9/16	2450
245	165	44	42 15/16	61	60 5/8	57	24 13/16	9	32 9/16	2730
270	175	48	46 15/16	61	64 5/8	62	26 9/16	9	36 9/16	3100
300	197	52	50 15/16	74	69 7/16	68	29 13/16	9	40 9/16	3780
330	206	56	54 13/16	74	75 15/16	73	33 1/16	9	44 9/16	4730
365	233	62	60 3/4	89	81 5/8	82	35 1/16	11	46 7/16	5930
402	247	67	65 5/8	89	89 5/16	90	41 5/16	11	50 3/8	6580
445	276	74	72 5/8	89	96 1/8	102	47 1/16	13	55 3/8	7050
490	305	80	78 1/2	101	104 1/16	113	57 5/16	13	59 3/16	11050
540	336	87	85 3/8	101	111 3/8	126	66 1/16	15	62 3/16	12550
600	376	96	94 3/8	101	120 5/16	144	81 9/16	15	69 3/16	14950

ALL DIMENSIONS IN INCHES. WEIGHTS IN LBS., LESS MOTOR.

* RECOMMENDED CURB OUTSIDE SQUARE DIMENSION.

** MIXING BOX INSIDE SQUARE DIMENSION.

*** DIMENSION IS FROM THE BOTTOM OF THE CURB CAP TO THE TOP OF THE CURB.

NOT INTENDED TO BE SUPPORTED BY TRADITIONAL SHEETMETAL ROOF CURB, BUT BY INTEGRAL MEMBERS OF ROOF STRUCTURE. **** WINDLOAD RATING DEPENDANT ON ADEQUATE ATTACHMENT TO ROOF STRUCTURE.

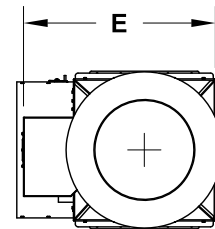
STANDARD CONSTRUCTION FEATURES:

High efficiency, non-overloading mixed-flow welded wheel - Minimum 14 gauge steel welded housing - Welded aerodynamic straightening vanes - Double concentric accelerator fiberglass reinforced plastic induction nozzle and windband - Phenolic epoxy powder with UV protection (Light Gray) - L10/40k Concentric locking regreasable bearings - Bolted access door - Lifting lugs - Fan drain - Weather cover - Reinforced curb cap - Inlet duct collar - Stainless Steel shaft - Stainless Steel hardware - Stainless Steel extended lube lines - NEMA 3R disconnect mounted and pre-wired - 1.5 Service factor drives - Designed to withstand 125 mph wind****

BYPASS PLENUM: Single wall welded steel construction with inner angle frame - Bottom inlet location - Phenolic epoxy powder with UV protection (Light Gray) - Plenum drain - Bolted access door - Painted aluminum bypass damper with manual hand quadrant - Weather hood - Stainless steel birdscreen - Stainless Steel hardware - Designed to withstand 125 mph****

OPTIONAL FEATURES SHOWN:

Heavy Duty Lab Exhaust Curb
 Side Intake Opening
 Isolation Damper
 Damper Actuator

